

SOUL6000D™



JETS – 42



SEATING – 7 seats



DIMENSIONS – 5.91 x 2.31 x 1.49m



SPECIFICATIONS

Dry weight*	1,399 kg
Water capacity	9,793 litres
Filled weight*	11,251kg
SmartFlo™ jet pump(s)	4 x 2.5 hp
SmartFlo™ circulation pump	2
Electrical requirements	32 + 15 amp
Heater	5.25 + 3 KW

* Does not include optional upgrade ClearLift™ cover weight.

WARRANTIES

Frame	Lifetime
Shell structure	10yrs
Acrylic surface	5yrs
Jets, plumbing & heater	5yrs
Pumps & equipment	2yrs**

FEATURES

- FourCore™ shell construction
- SunFlex™ plumbing system
- SpaNet SV3+SVM1™ control system
- SoftTouch™ head rest
- SunFrame™ galvanised steel frame
- Ozone automatic water clarifier
- Stainless steel jets
- Wide mouth filtration
- SunGlow™ in-spa illumination
- Integrated heat pump control
- Soul™ hydrotherapy lounger

OPTIONS

- UV automatic water steriliser
- Sun & Soul™ Audio & WiFi Kit
- SpaNet™ SV Series heat pump
- Sun & Soul™ swim pole kit
- ClearLift™ cover lifter

* Check with electrician about dedicated circuit requirements.
**Conditions apply. Specifications may change without notice.
May be pictured with some options included.



To access the SOUL6000™ Structural certificate, please click or scan the QR code below.



SOUL6000D™ Spa
Structural Certificate

To access the Sun & Soul™ Spas owner's Manual/ Audio WiFi Kit Manual/ SpaNet™ SV Series Heat Pump Installation Manual/ Sun & Soul™ Spas Warranty, please click or scan the QR code bellow.



Sun & Soul™ Spas
Owner's Manual



Sun & Soul™ Spas
Audio WiFi Kit Manual



SpaNet™ SV Series Heat
Pump Installation and
Instruction Manual

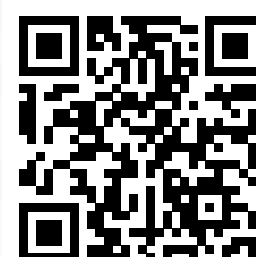

Sun & Soul™ Spas
Warranty

SOUL6000D™

Optional Upgrade ClearLift™ Cover

Left-mounted opening

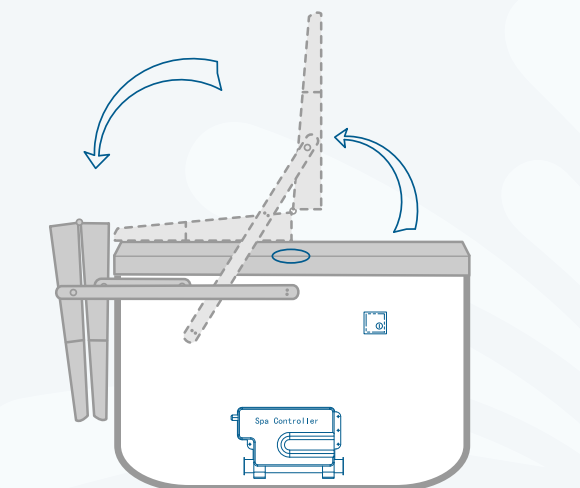

Right-mounted opening

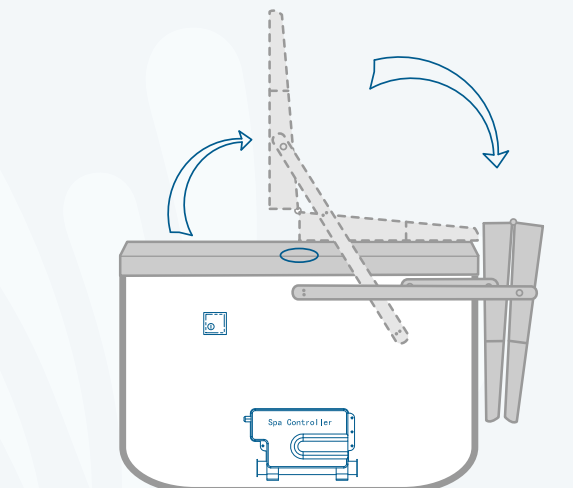

If the ClearLift™ control panel is positioned on the right side of the swim spa, and the ClearLift™ cover folds to the left, it is considered a Left-Mounted ClearLift™.

Conversely, if the ClearLift™ control panel is located on the left side of the swim spa, and the ClearLift™ cover folds to the right, it is referred to as a Right-Mounted ClearLift™.

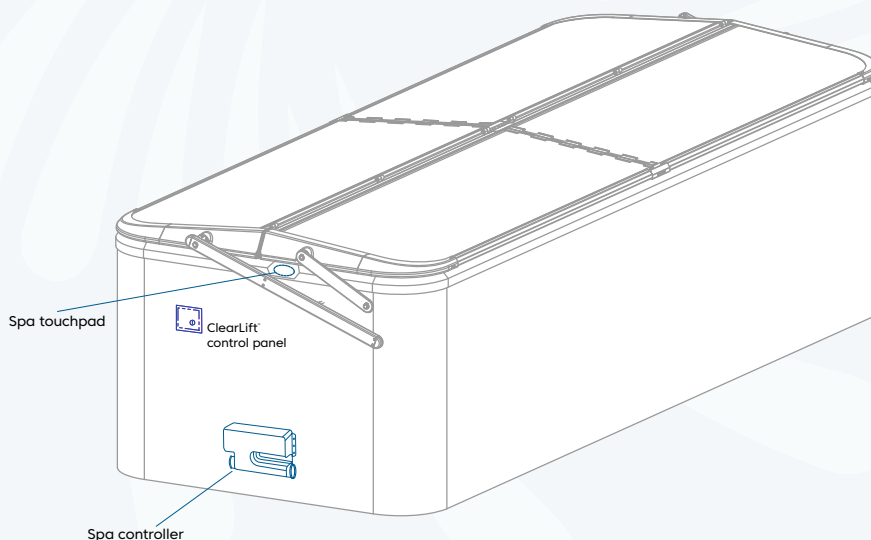

*The illustration shows Right-mounted opening, side angle view.

Note: The ClearLift™ control panel is installed at the same end as the swim spa controller keypad.

SOUL6000D™

Optional Upgrade ClearLift™ Cover

Left mount, side view shown in Sun & Soul™ swim spas 1,500mm height.

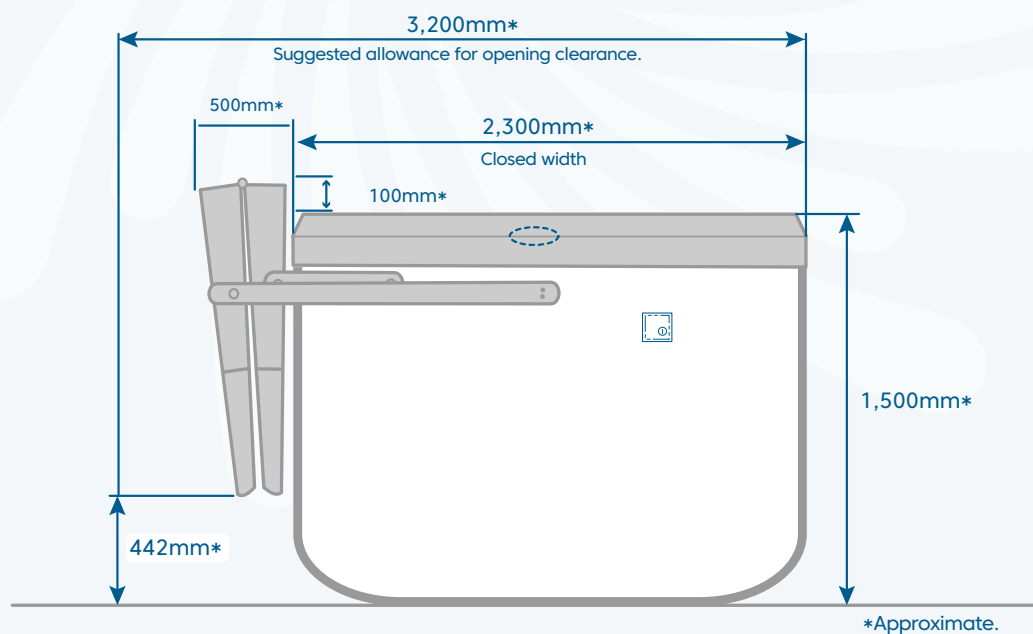
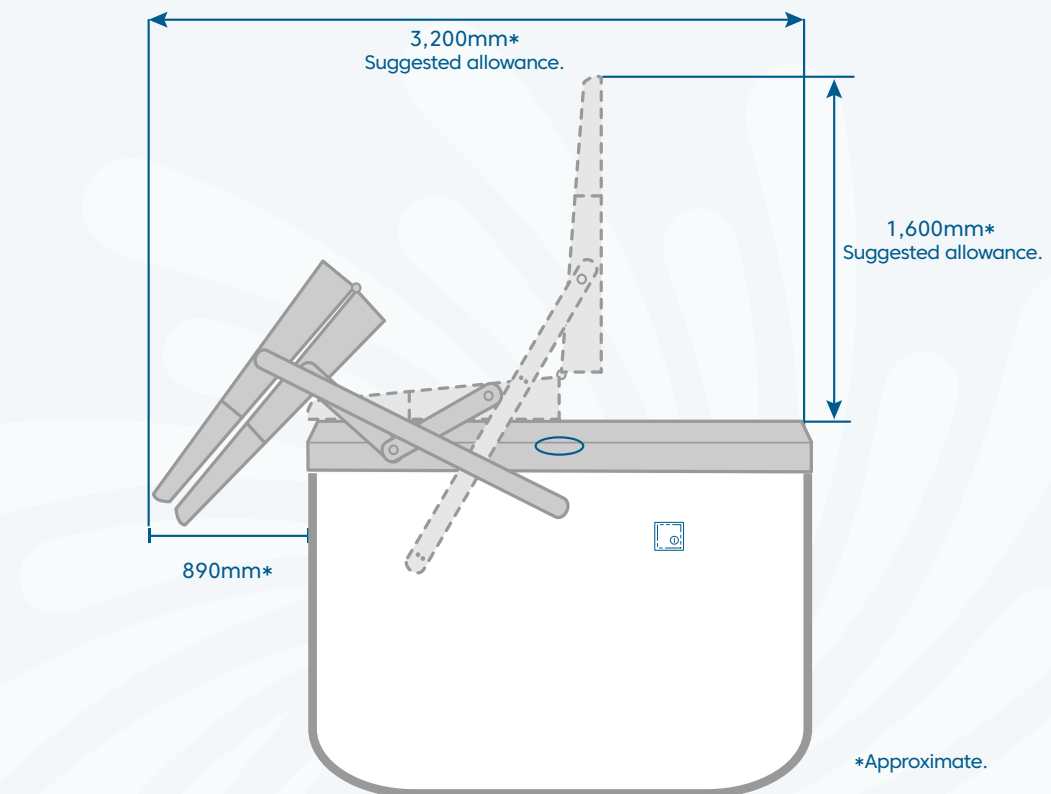

To access the ClearLift™ Cover Installation Manual, please click or scan the QR code bellow.

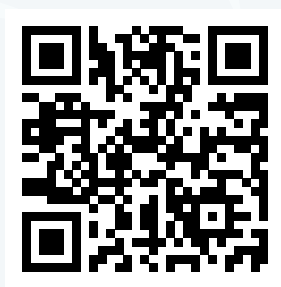

ClearLift™ Cover
Installation Manual