

SOUL4000™



JETS – 34



SEATING – 5 seats



DIMENSIONS – 3.96 x 2.29 x 1.30m



SPECIFICATIONS

Dry weight*	914 kg
Water capacity	5,700 litres
Filled weight*	6,649 kg
SmartFlo™ jet pump(s)	3 x 2.5 hp
SmartFlo™ circulation pump(s)	1
SmartFlo™ air blower	1
Electrical requirements	32 amp
Heater	5.25 KW

* Does not include optional upgrade ClearLift™ cover weight.

WARRANTIES

Frame	Lifetime
Shell structure	10yrs
Acrylic surface	5yrs
Jets, plumbing & heater	5yrs
Pumps & equipment	2yrs**

FEATURES

- FourCore™ shell construction
- SunFlex™ 'no kink' PVC plumbing
- SunFrame™ galvanised steel frame
- RuggedBase™ insulated, moulded ABS base
- UV automatic water steriliser
- Ozone automatic water clarifier
- Stainless steel jets
- SunGlow™ in-spa illumination
- SunGlow™ LED perimeter lighting
- SunGlow™ programmable lighting
- SpaNet SV3™ premium control system

OPTIONS

- Sun & Soul™ Audio & WiFi Kit
- SpaNet™ SV Series heat pump
- Sun & Soul™ swim pole kit
- ClearLift™ cover lifter

* Conditions apply. Specifications may change without notice.
May be pictured with some options included.

To access the SOUL4000™ Plumbing Certificate/ Structural Certificate, please click or scan the QR code below.



SOUL4000™ Spa
Plumbing Certificate



SOUL4000™ Spa
Structural Certificate

To access the Sun & Soul™ Spas owner's Manual/ Audio WiFi Kit Manual/ SpaNet™ SV Series Heat Pump Installation Manual/ Sun & Soul™ Spas Warranty, please click or scan the QR code bellow.



Sun & Soul™ Spas
Owner's Manual

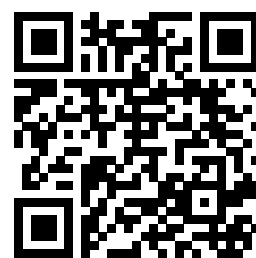

Sun & Soul™ Spas
Audio WiFi Kit Manual



SpaNet™ SV Series Heat
Pump Installation and
Instruction Manual



Sun & Soul™ Spas
Warranty

Left-mounted opening

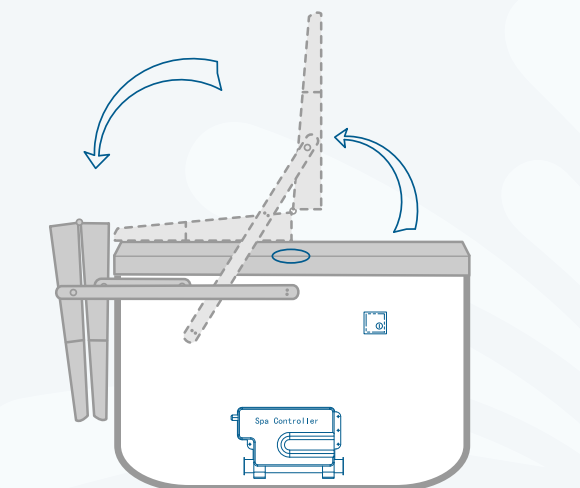

Right-mounted opening

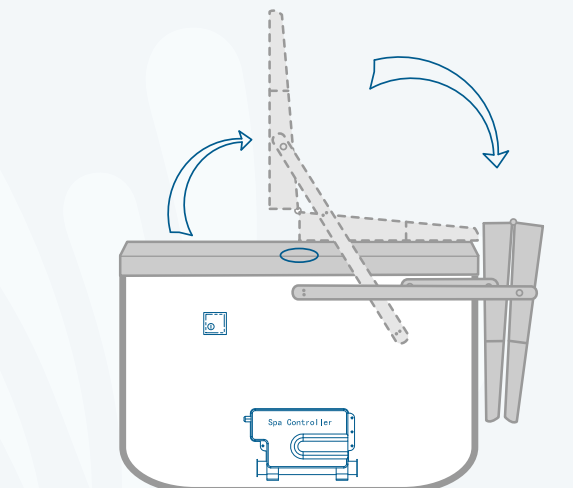

If the ClearLift™ control panel is positioned on the right side of the swim spa, and the ClearLift™ cover folds to the left, it is considered a Left-Mounted ClearLift™.

Conversely, if the ClearLift™ control panel is located on the left side of the swim spa, and the ClearLift™ cover folds to the right, it is referred to as a Right-Mounted ClearLift™.

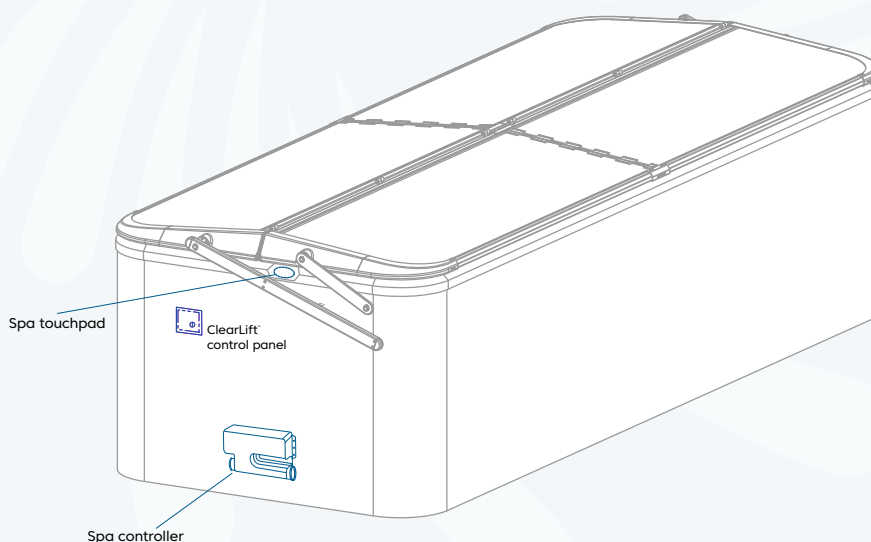

*The illustration shows Right-mounted opening, side angle view.

Note: The ClearLift™ control panel is installed at the same end as the swim spa controller keypad.

Left mount, side view shown in Sun & Soul™ swim spas 1,300mm height.

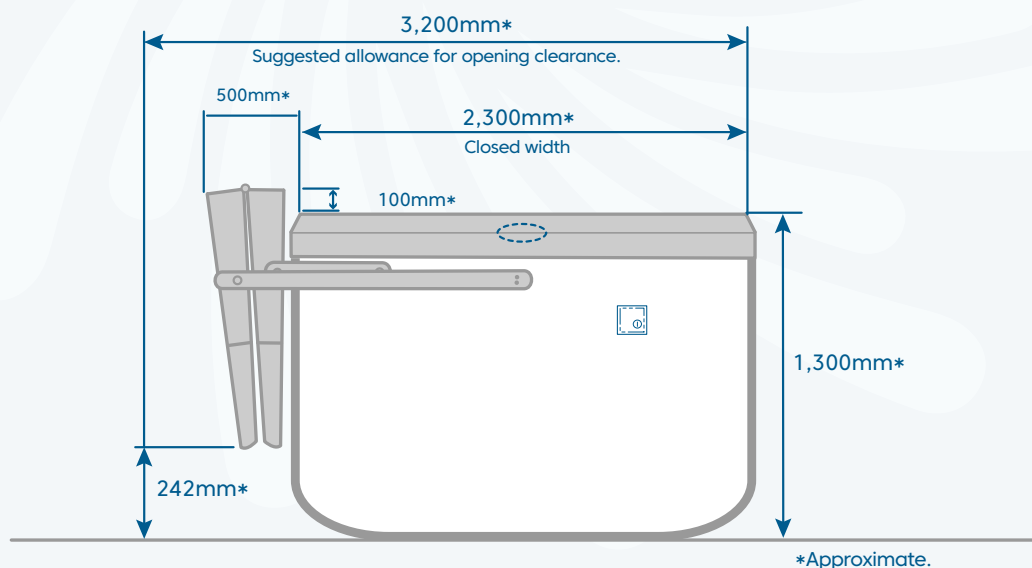
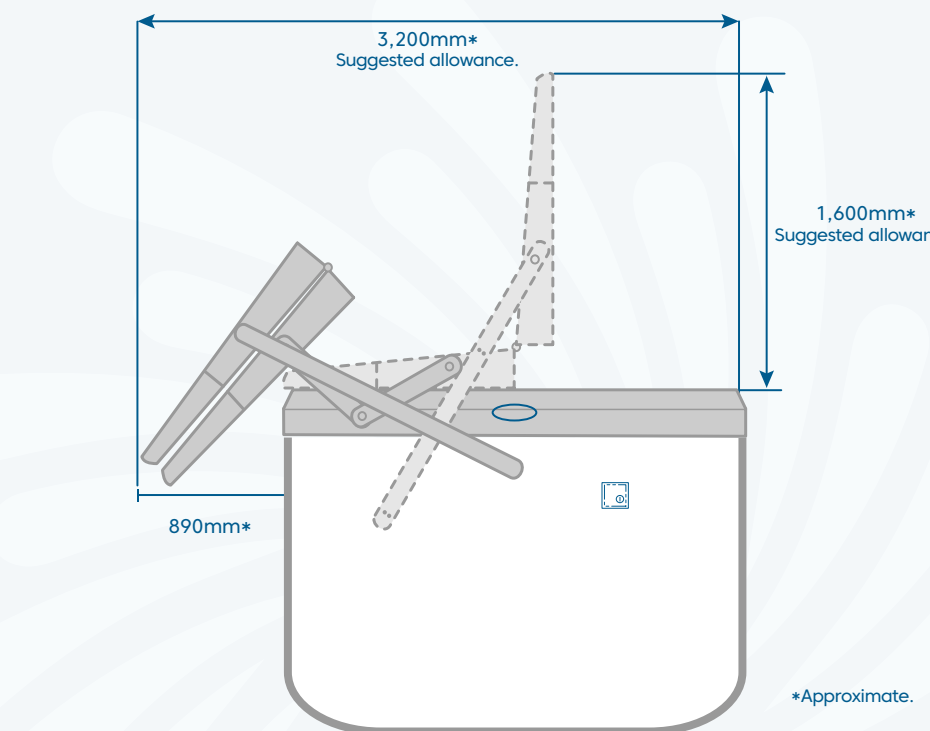

To access the ClearLift™ Cover Installation Manual, please click or scan the QR code below.

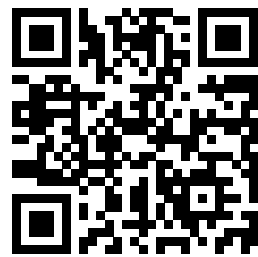

ClearLift™ Cover
Installation Manual